

HALLS GAP MARKET

GUIDELINES

All proceeds go to the Halls Gap Primary School

Market	Location	Cost per site
Labour Day	Halls Gap School	\$ 30.00
Easter Sunday	Halls Gap School	\$ 40.00
Queen's Birthday	Halls Gap School	\$ 30.00
Melbourne Cup Weekend	Halls Gap School	\$ 30.00

Contact Information

Facebook – providing up to date information and answers to frequently asked questions. Facebook Page is “Halls Gap Market”, like us to receive updates as they occur or ask Questions for a prompt reply:

<https://www.facebook.com/HallsGapMarket/>

- **Mail** – Fundraising Craft Market, Halls Gap Primary School, Halls Gap VIC 3381
- **Telephone** – 0477 702 899
- **Website** – www.hgps.vic.edu.au/craft.html

General Information

- **Market Aim** – To provide an outlet for crafts and producers of home made goods to sell in an informal outdoor environment.
- **Prebooking** – We do not pre-book sites.
- **The Goods** – Quality handcrafted, homemade or home grown items (stalls must contain at least 70% homemade). No second hand goods stalls are acceptable.
- **Conditions** – No livestock/pets are to be sold; there are no powered sites available; generators are not permitted.
- **Liquor Stalls** – Must display their liquor licence.
- **Food Stalls** – Are required to PRE prepare and package food in a registered kitchen in accordance with food and health requirements. Certificates should be available for inspection at all markets. Food is to be prepared in accordance with current food handling regulations. A BBQ, tea and coffee stall is run by the Halls Gap School Parents on the day. *No other takeaway or beverage stalls will be permitted.*
- **Site Fees** – Are payable on the day of the market.
- **Site Size** – Each site measures 3 metres by 3 metres.
- **Walkways** – Are to remain clear at all times.
- **Insurance** – It is required that shall holders have their own adequate appropriate insurance cover for damage, loss or injury.
- **Advertising** – This market is extensively advertised via notice boards, accommodation venues and tourist information centres in Halls Gap, Stawell and Ararat. Advertisements are also placed with media sources (TV, radio, newspapers, and internet).

Market Day Information

- **Operating Times** – 9:00am until 1:00pm (approx.)
- **Setting Up Site** – Cannot commence until Sunrise on day of market. Sites are allocated on a first served basis. Overnight camping within the school grounds is not permitted.
- **Gates** – Will be locked from 9:00am until 1:00pm.
- **Site Types** – Parts of the school have no vehicle access, whilst other areas of the school are available for vehicles to remain on site during the market. Please refer to the map below for clarification of vehicle areas.
- **Packing Up Site** – Care is required when vacating the school grounds. No vehicle movements are permitted during the market operating times.
- **Toilets** – will be opened at 8am on the day of the market. Prior to this time, available toilets are in front of the swimming pool.
- **General** - Do not staple or nail anything to the trees, school equipment or buildings. No pets are permitted in the school grounds on market days.
- **Non Smoking Policy** – All school areas are no smoking.
- **Weather** – the Market is conducted in the open air it is not a covered market, and will operate in varying weather conditions including wet weather. It is the responsibility of the Stallholder to bring their own covers, weights to hold down equipment and other equipment for the purpose of protection in adverse weather conditions. **The Market will NOT be cancelled in the event of inclement weather conditions.**
- **Refunds** – No credits or refunds are issued in the case of bad weather or weather deterioration on Market day. The Market will trade in all weather conditions. Please do not apply for a stall unless you are prepared to take the risk on weather.
- **CODE RED and EXTREME FIRE DANGER DAYS** – PLEASE NOTE: on days of **CODE RED** or **EXTREME FIRE DANGER DAYS** the Market will be **CANCELLED**. Please check the Facebook page and listen to local radio stations for updates.
- **Buskers** – Please contact the school prior to the Market for approval to busk.

Vehicle Access

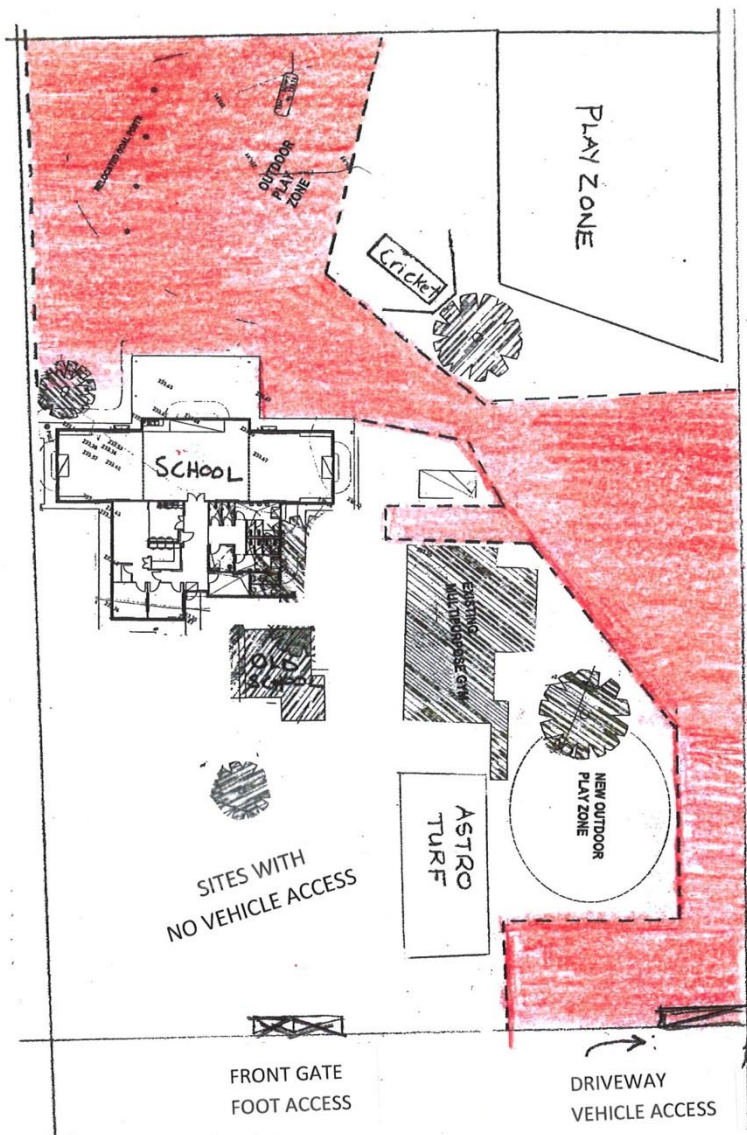

School Layout
(not to scale)

Dotted Shaded Area
is vehicle accessible
on Market Day



Stall Layout for Easter Market

